

for 4WD and Pre-Runner:

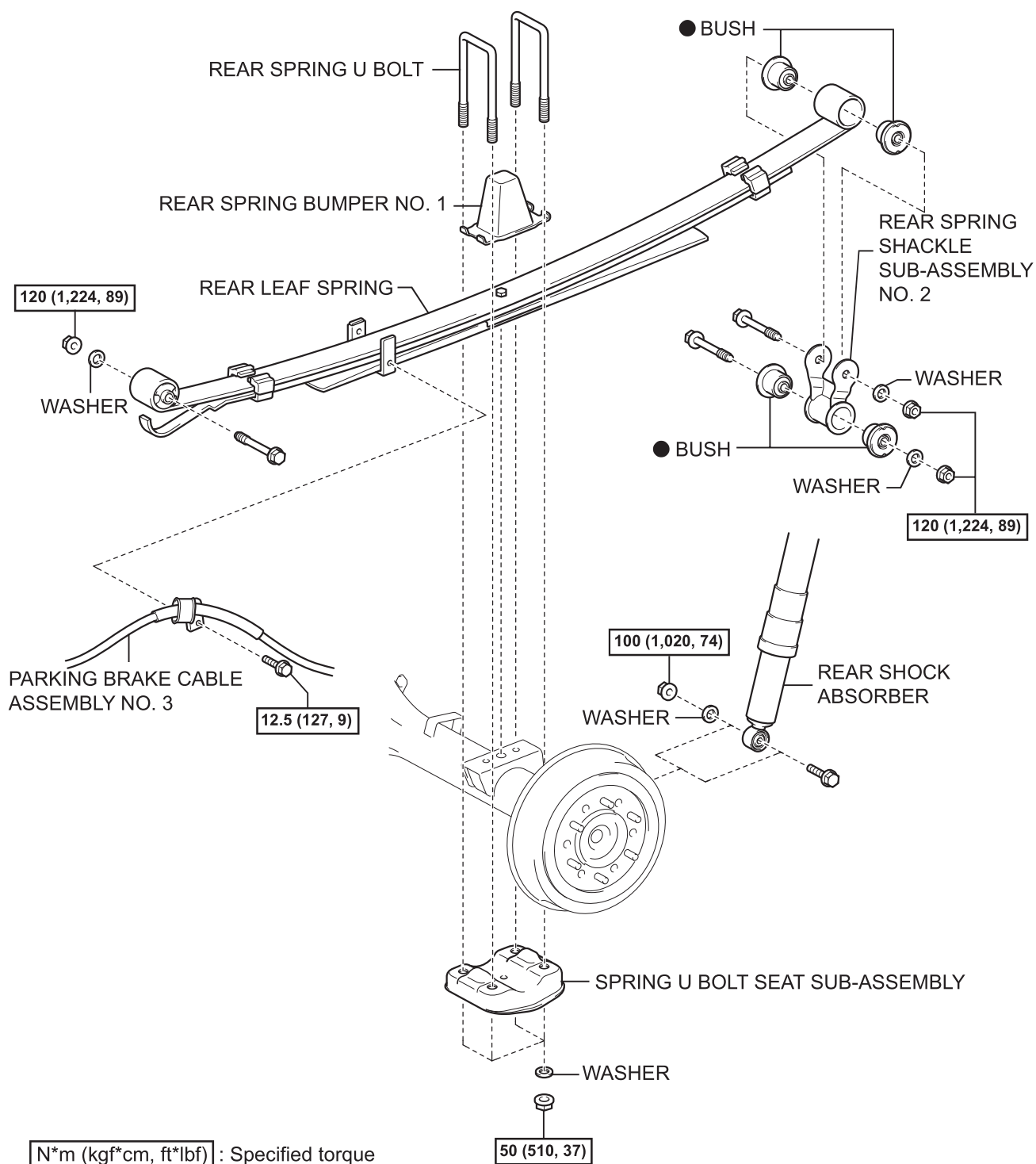

SP

REMOVAL

1. REMOVE REAR WHEEL
2. REMOVE SPARE TIRE (for 4WD and Pre-Runner)
3. SEPARATE REAR SHOCK ABSORBER
 - (a) Support the rear axle housing.
 - (b) Remove the bolt, nut and washer.
 - (c) for 2WD:
 - (1) Separate the shock absorber from the rear spring seat.
 - (d) for 4WD and Pre-Runner:
 - (1) Separate the shock absorber from the rear axle housing.

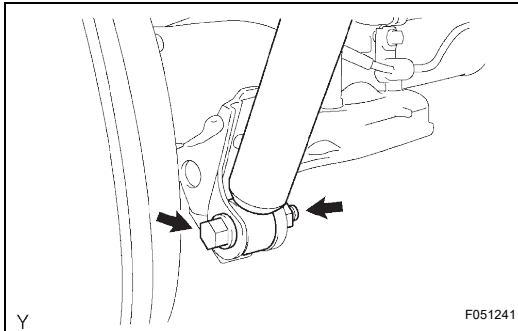

4. SEPARATE PARKING BRAKE CABLE ASSEMBLY NO. 3
 - (a) Remove the bolt, then separate the parking brake cable.

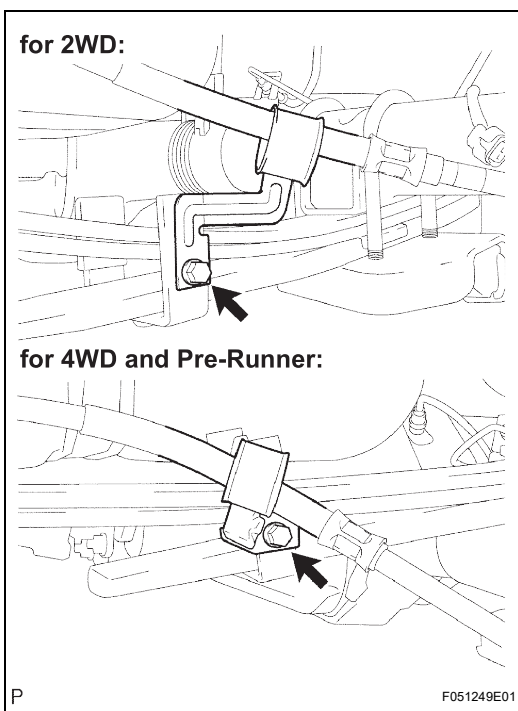

5. REMOVE REAR SPRING BUMPER NO. 1 (for 2WD)
 - (a) Remove the 2 nuts and spring bumper.

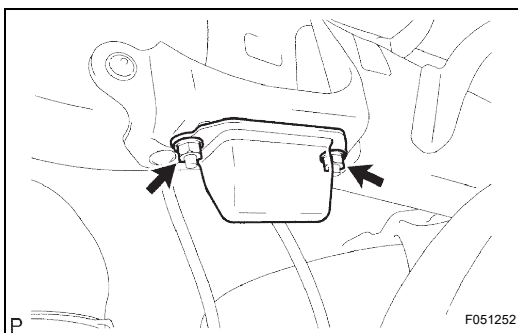

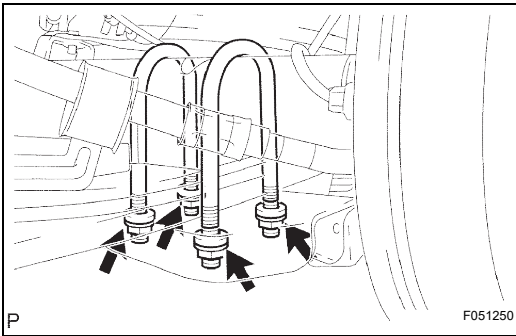

6. REMOVE REAR SPRING U BOLT (for 2WD)

- Remove the 4 nuts and 4 washers.
- Remove the spring seat and 2 U-bolts.

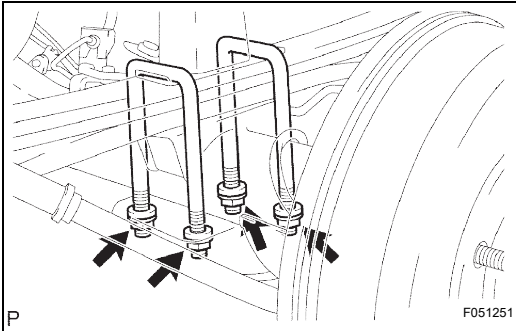

7. REMOVE REAR SPRING U BOLT (for 4WD and Pre-Runner)

- Remove the 4 nuts and 4 washers.
- Remove the spring seat and 2 U-bolts.
- Remove the spring bumper.

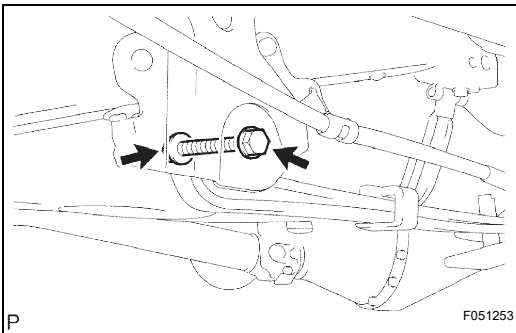

8. REMOVE REAR LEAF SPRING

- Remove the nut, washer and through bolt.

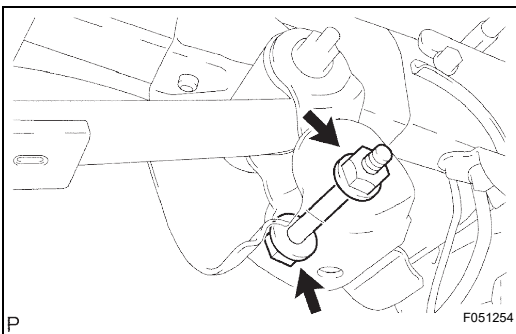

- Remove the nut, washer and through bolt.

NOTICE:

Be careful not to drop the spring when removing the through bolt.

- Remove the spring

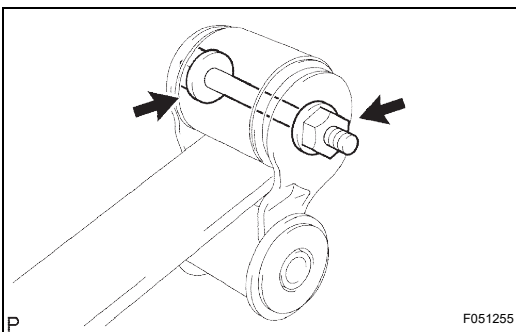

9. REMOVE REAR SPRING SHACKLE SUB-ASSEMBLY NO. 2

- Remove the nut, washer, through bolt and shackle.

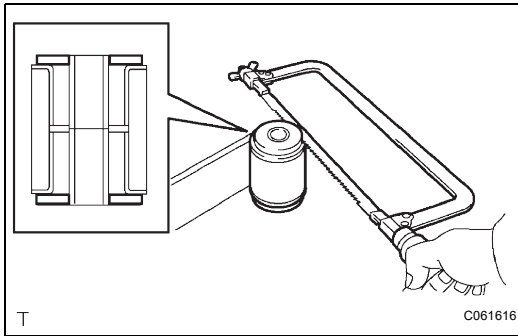

DISASSEMBLY

1. REMOVE BUSH

- (a) Fix the spring in a vise.
- (b) Using a hack saw, cut both ends off the bushes.

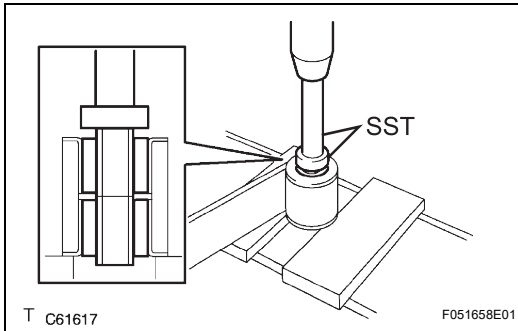

- (c) Using SST and a press, press out the 2 bushes.
SST 09950-60010 (09951-00350), 09950-70010 (09951-07100)

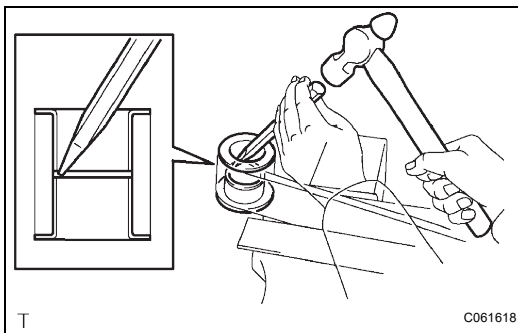

- (d) Using a chisel and hammer, tap out the 2 outer tubes.

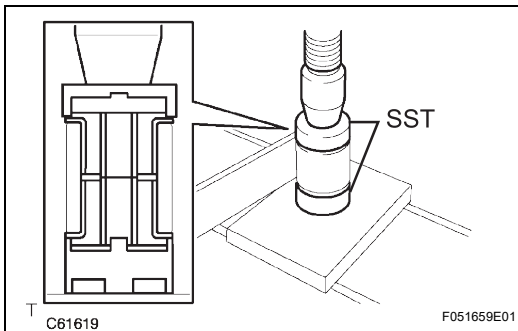

REASSEMBLY

1. INSTALL BUSH

- (a) Using SST and a press, press in 2 new bushes.
SST 09710-28012 (09710-07062), 09710-30041 (09710-03211)

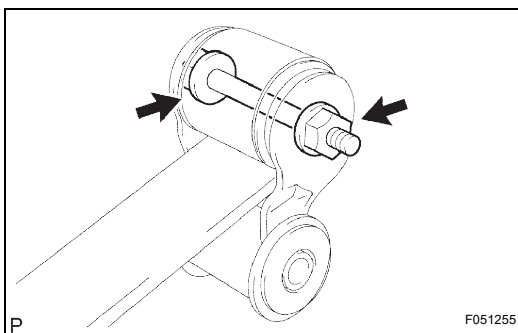

INSTALLATION

1. INSTALL REAR SPRING SHACKLE SUB-ASSEMBLY NO. 2

- (a) Install the shackle with the through bolt, washer and nut.

2. INSTALL REAR LEAF SPRING

- (a) Place the spring in the rear axle housing.
- (b) Align the hole of the rear axle housing with the head of the spring center bolt.

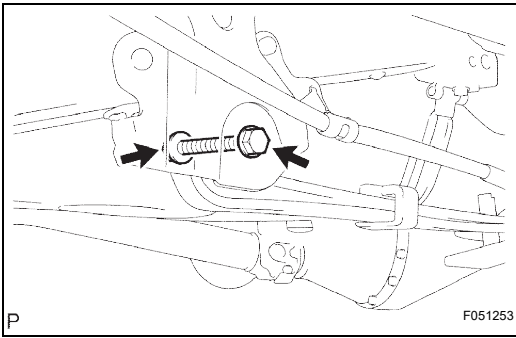

(c) Install the through bolt, washer and nut.

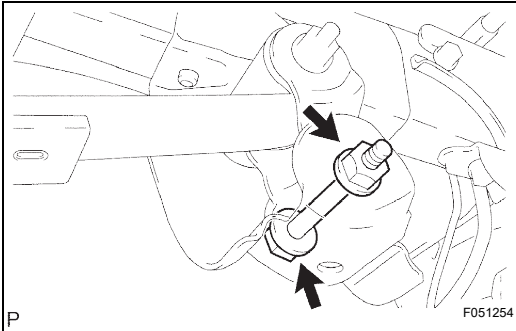

(d) Install the through bolt, washer and nut.

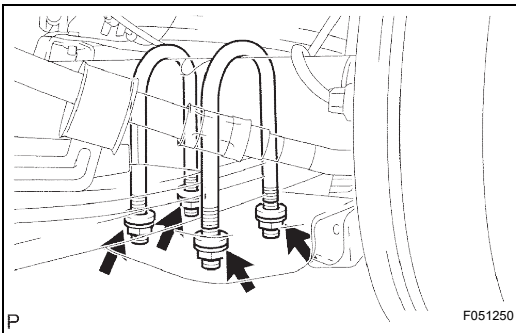

3. INSTALL REAR SPRING U BOLT (for 2WD)

- (a) Install the spring seat, 2 U-bolts, 4 washers and 4 nuts.

Torque: 50 N*m (510 kgf*cm, 37 ft.*lbf)

HINT:

Tighten the U-bolts until the lengths of all the U-bolts under the spring seat are the same.

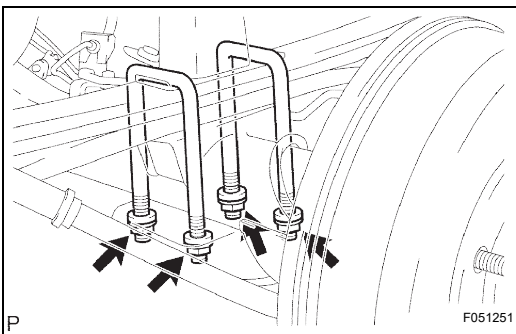

4. INSTALL REAR SPRING U BOLT (for 4WD and Pre-Runner)

- (a) Install the spring bumper.
- (b) Install the spring seat, 2 U-bolts, 4 washers and 4 nuts.

Torque: 50 N*m (510 kgf*cm, 37 ft.*lbf)

HINT:

Tighten the U-bolts until the lengths of all the U-bolts under the spring seat are the same.

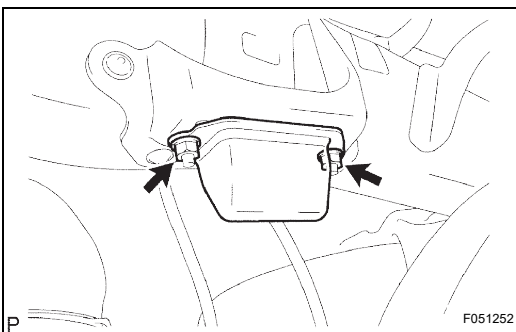

5. INSTALL REAR SPRING BUMPER NO. 1 (for 2WD)

- (a) Install the spring bumper with the 2 nuts.

Torque: 15 N*m (153 kgf*cm, 11 ft.*lbf)

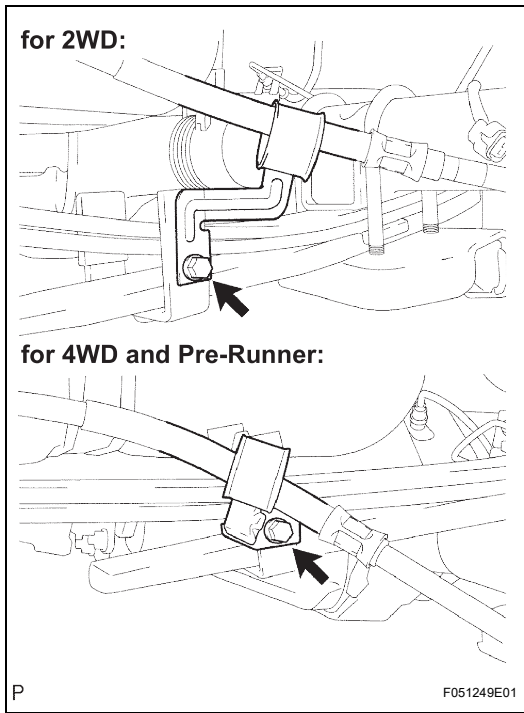

6. INSTALL PARKING BRAKE CABLE ASSEMBLY NO. 3

- (a) Install the parking brake cable with the bolt.
Torque: 12.5 N*m (127 kgf*cm, 9 ft.*lbf)

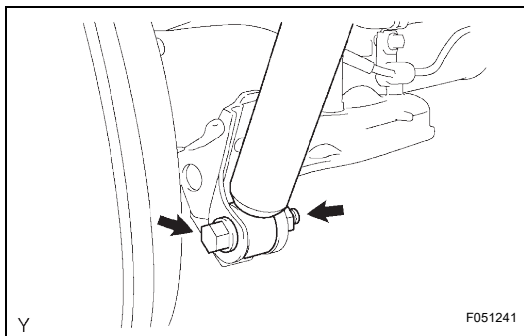

7. INSTALL REAR SHOCK ABSORBER

- (a) Install the shock absorber with the bolt, nut and washer.

8. INSTALL REAR WHEEL

Torque: 113 N*m (1,152 kgf*cm, 83 ft.*lbf)

9. STABILIZE SUSPENSION

- (a) Jack down the vehicle.
(b) Bounce the vehicle up and down several times to stabilize the suspension.

10. FULLY TIGHTEN REAR SUSPENSION

- (a) Tighten the nuts and bolts of the rear suspension parts.

Part Tightened	N*m	kgf*cm	ft.*lbf
Rear LH spring x Rear spring shackle	120	1,224	89
Rear LH spring x Frame	120	1,224	89
Rear spring shackle x Frame	120	1,224	89
Rear shock absorber x Rear spring seat (2WD)	100	1,020	74
Rear shock absorber x Rear axle housing (4WD and Pre-Runner)	100	1,020	74

11. INSTALL SPARE TIRE (for 4WD and Pre-Runner)